

## DIY Oz Drawer Instruction Manual

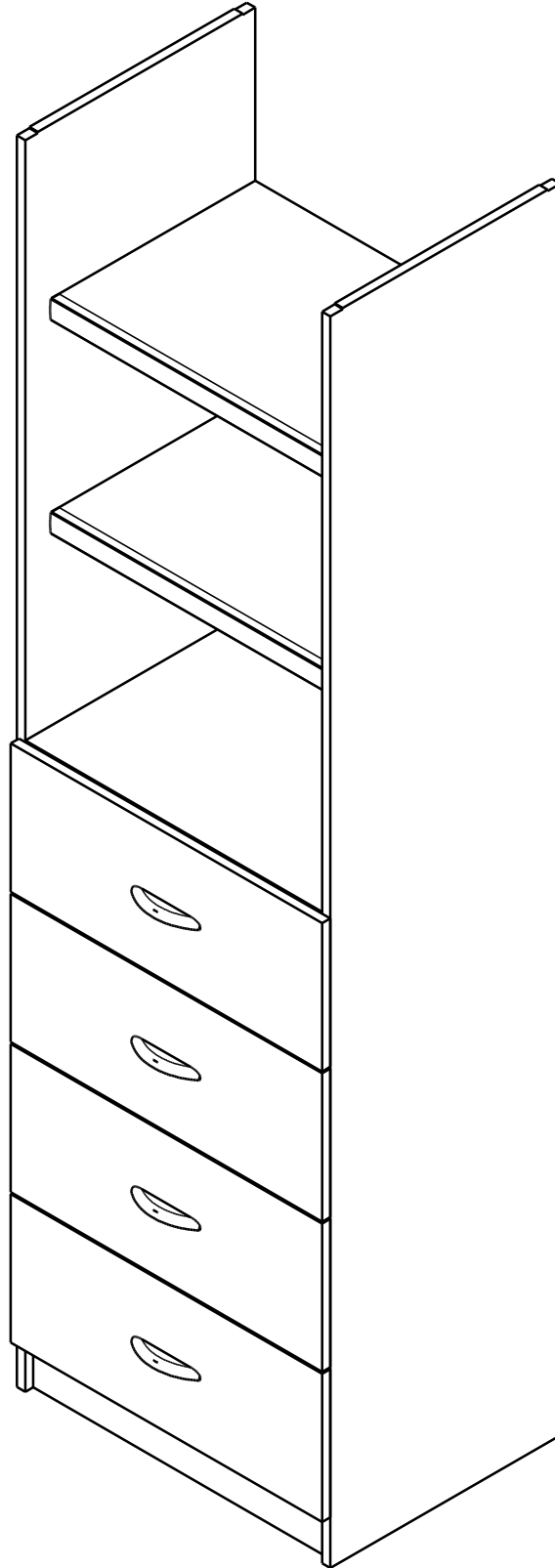

## **COPYRIGHT**

This technical manual remains the property of Oz Shelving Systems Pty Limited and contains privileged information which is the subject of copyright and the manual or any part thereof may not be reproduced, copied or loaned in any form without the written permission of Oz Shelving Systems Pty Limited.

This manual is to be returned to Oz Shelving Systems Pty Limited when requested.

## **DISCLAIMER**

Whilst every effort has been made to ensure the technical details contained within this manual are accurate, Oz Shelving Systems Pty Limited can take no responsibility for any loss or damage whatsoever arising as a result of any errors contained in this manual.

Also, interpretation of standards or codes within this manual is Oz Shelving Systems Pty Limited interpretation for such codes. Responsibility for code compliance remains with the user of this manual. In some cases product dimensions may vary or be changed without notice. The user of this manual should not act or rely upon on any information contained in this manual without first obtaining appropriate professional advice relating to their particular circumstances.

Oz Shelving Systems Pty Limited disclaims all liability for loss or damage suffered by any party who acts or fails to act in reliance of this manual.

## **Table of contents**

<b>Page 1</b>	Tower Configuration
<b>Page 2</b>	Oz Drawer Tower Parts - 1
<b>Page 3</b>	Oz Drawer Tower Parts - 2
<b>Page 4</b>	Tower Assembly
<b>Page 5</b>	Oz Drawer Assembly

---

## Revisions

Date	Amendment details	Issue version
30/10/21	Initial issue	A

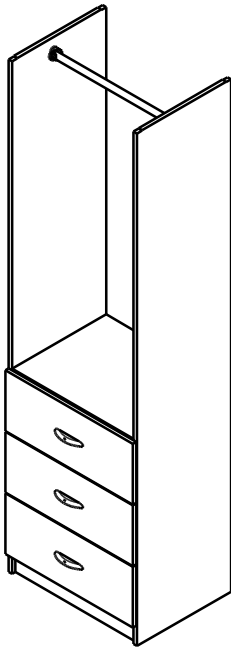

2077 x 440 - 3 Drawer with Rod

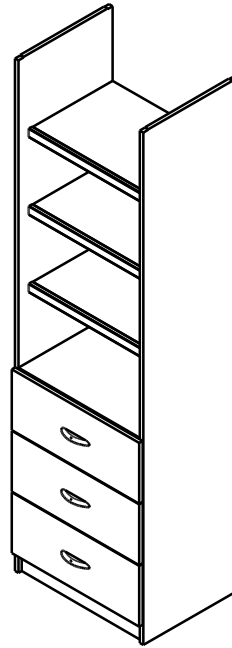

2077 x 440 - 3 Drawer 3 Shelves

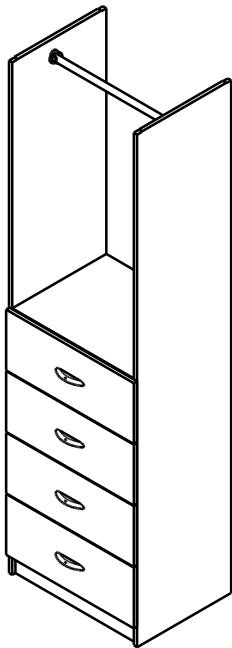

2077 x 440 - 4 Drawer with Rod

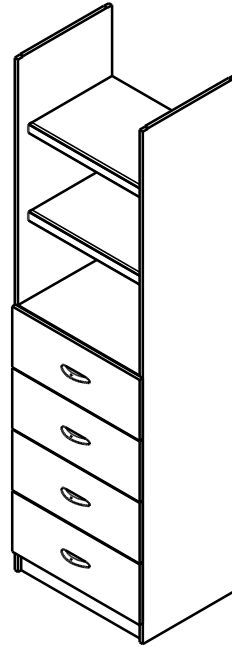

2077 x 440 - 4 Drawer, 2 shelves

**Specifications:**

Maximum tower carcass width: 900mm

Minimum tower depth: 410mm (overlay drawer)

426mm (inlay drawers)

\*\*\* no top cleat, use system 32 bracket\*\*

440mm with glass top

Gables pair 1L (LH shown)

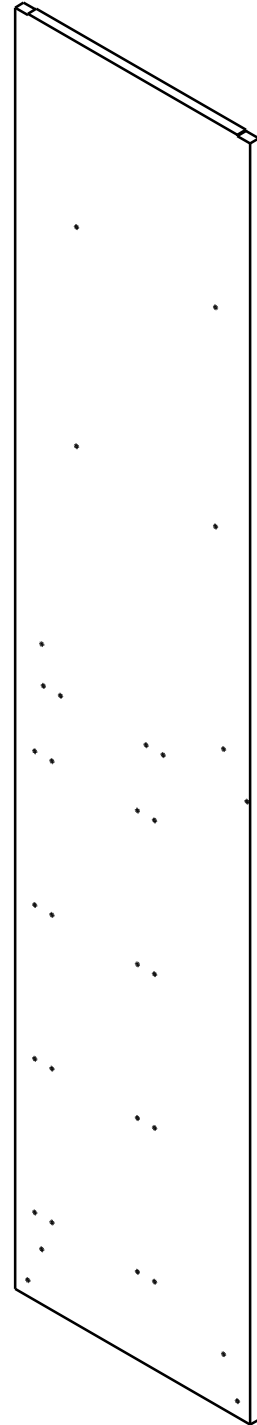
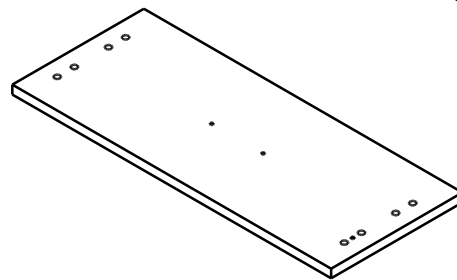
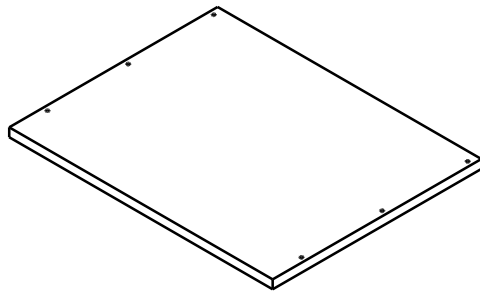
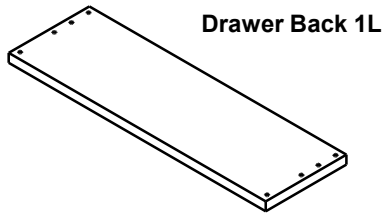
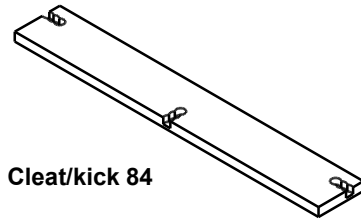
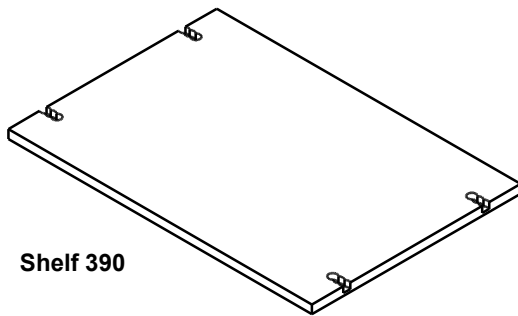
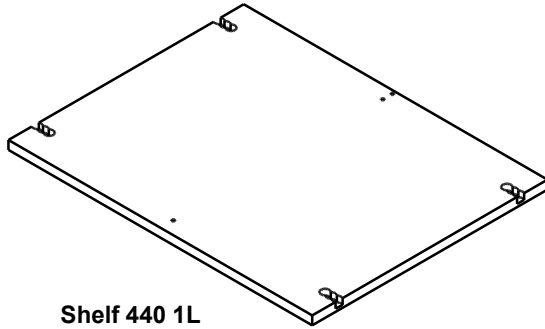

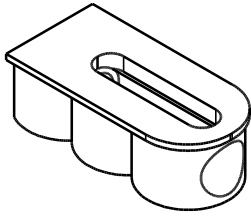

**Cabineo cams (100 pack)**

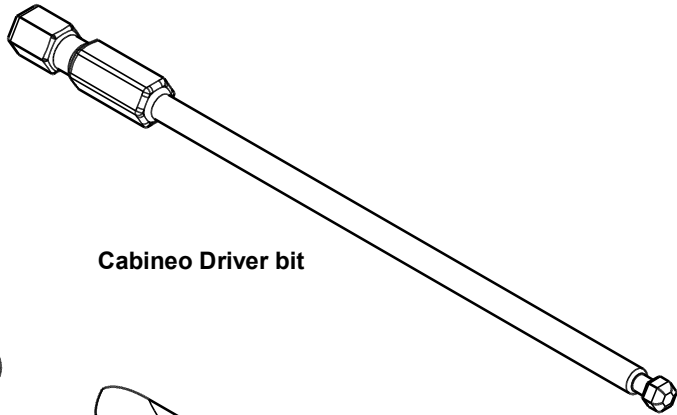

**Cabineo Driver bit**



**Euro Screw (1000 pack)**

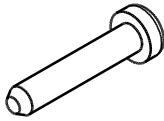

**Handle Screws (100 pack)**

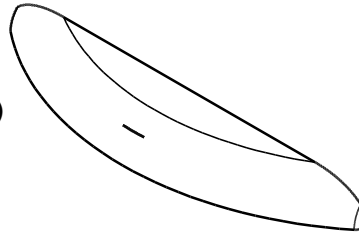

**Handle (25 pack)**

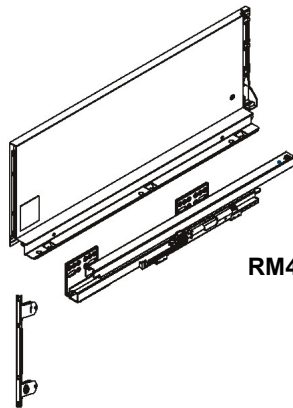

**RM417(167-400) Soft close drawer (4 pack) NTS**

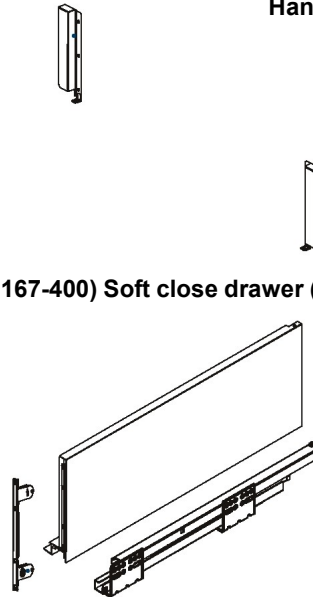

**RM407(69-400) Soft close drawer (4 pack) NTS**

