



**WARDROBES®**

**SIMPLY  
BETTER  
STORAGE  
SOLUTIONS**



[ozwardrobes.com.au](http://ozwardrobes.com.au)



## LOCATIONS

Oz Wardrobes is a growing group of privately owned, independent distributors of the Oz Shelving Systems: Rapi-Mount, Dura-Mount & Multi-Glide Sliding Doors.

See our website for current locations.

## ABOUT US

Since 2009 we have installed thousands of wardrobe sliding doors and internal fit-outs in the Brisbane area.

At Oz Wardrobes, we've teamed up with independent wardrobe companies across Australia who are licensed and trained to supply and install our range of products. While we also have branded distributors, this partnership makes it easier for you to work with a local distributor in your area. Regardless of which distributor you choose, you can expect the same high-quality products and excellent customer service that Oz Wardrobes is known for.

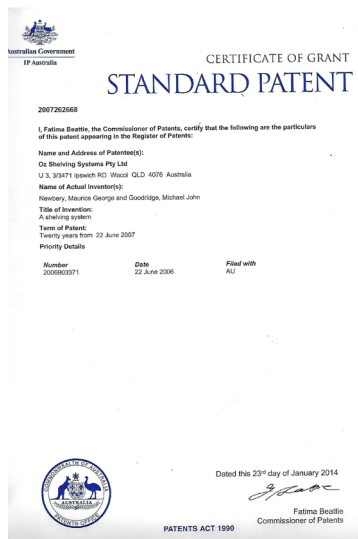

## PATENT CERTIFICATE

Since 2007 the Oz Wardrobes range of products have been conceived, refined and tested to give you, the customer, complete product satisfaction (10 year warranty).

Rapi-Mount Shelving System has been awarded an Australian Standard Patent (2006903371) for its design and installation feature.



**"OZZIE" APPROVED**

**10 YEAR WARRANTY**

*on all Oz Wardrobes Products*

## Founders and Owners of Oz Wardrobes

HQ: Wacol, Brisbane South



**Maurice Newbery**  
Business Owner  
*Oz Wardrobes Brisbane South*  
Director  
*Oz Shelving Systems P/L*



**Michael Goodridge**  
General Manager,  
Senior Design Engineer  
& Director  
*Oz Shelving Systems P/L*

**90% OF PARTS**  
manufactured in Australia

**10-Year Warranty** on all products

## DESIGN PROCESS

At Oz Wardrobes, we believe every wardrobe should be unique. Our friendly consultants will help you design a wardrobe tailored to your needs. We can work from your house plans or arrange an in-home consultation.

### FREE MEASURE & QUOTE

Our professionals take precise measurements to ensure that every component is manufactured and installed to fit the exact space it's intended for.

\*SKETCH FOR DEMONSTRATION PURPOSES ONLY

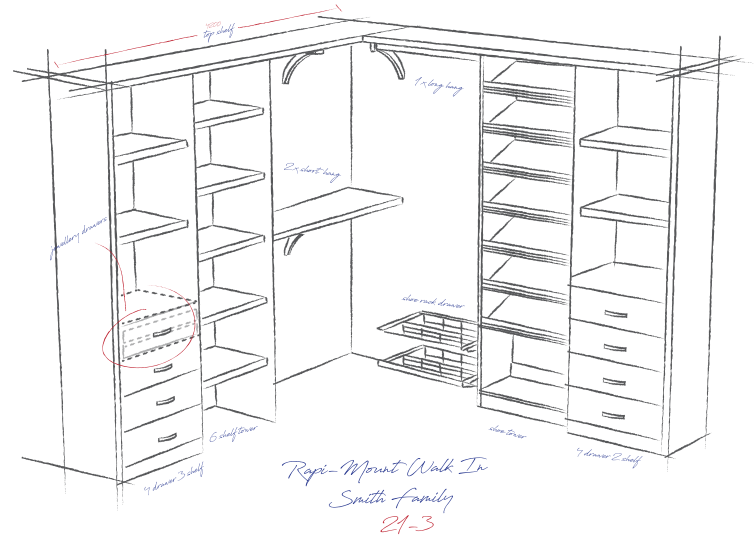

### 1 MEASURE & QUOTE

### 2 DIGITAL DRAWING

### 3 ORDER

### 4 INSTALLATION

Rapi-Mount & Dura-Mount Systems have a similar base price and are both built to the same high standard.

## HOW MUCH DO WARDROBES COST?

There are a few factors that affect the price of your new wardrobe, and your Oz Wardrobes specialist will systematically assess them in order to determine the most competitive price for your job.

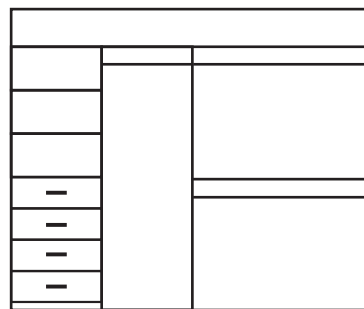

### Example

#### Reach-In Wardrobe

- Drawer Tower
- Long Hang
- Double Hang
- White Finish

**Internal Fit-out**  
Approx. Cost

**\$1500**

**Soft-close**  
**Mirror Sliding Doors**  
Approx. Cost

**\$920**



## Contents

### Rapi-Mount

Melamine shelving & drawers

### Dura-Mount

Ventilated shelving system

### Doors & Accessories

and other uses

### Design

Basic Steps for planning your wardrobe; details on design

Page

3 - 4

5 - 6

7 - 8

9 - 10

# RAPI-MOUNT

Melamine Shelving System

**CUSTOM-DESIGNED**  
to suit *your* space

## FEATURES & BENEFITS

### **Strong**

Unique aluminium shelf edges coupled with engineered fixings distributes the weight of your clothes to the structure of your home allowing you to hang more clothes in your wardrobe.

### **Flexible**

Choose from a wide range of colours and designs to compliment the look of your space.

### **Durable**

All our components are manufactured with quality in mind and are guaranteed for 10 years.

## LET US HELP YOU DESIGN YOUR DREAM WARDROBE



### Built-in Rapi-Mount Wardrobe

Trims available in white, matt-silver, black or brown.

Above image features: **A** Double Hang **B** Long Hang **C** Fixed Shoe Rack **D** Four Drawer, Two Shelves  
**E** Metal-sided, soft-close Drawers

# DRAWER TOWERS

Rapi-Mount Shelving System

Standard and custom sizes available to suit all wardrobe spaces

## FEATURES & BENEFITS

### Standard

Width: 450mm, 600mm & 900mm

Height: 1772mm & 2077mm

Depth: 480mm (including handle)

### Custom Sizes

Width: 400mm to 1000mm

Includes heavy duty drawers

- Available in mini drawer towers
- Single or double jewellery drawers
- Other colours available
- Choose between fixed or adjustable shelves or hanging space above drawers



3 Drawer Tower with Rod

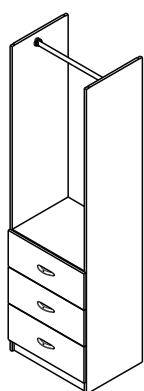

3 Drawer Tower, 3 Shelves

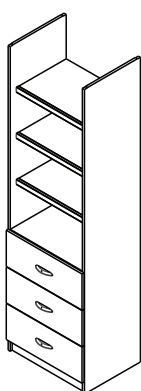

4 Drawer Tower with Rod

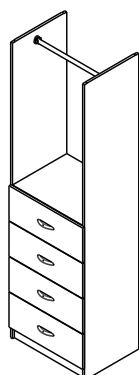

4 Drawer Tower, 2 Shelves

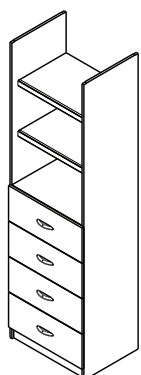

## METAL-SIDED DRAWERS

Melamine drawer face with satin nickel handles. Steel sides. 170mm tall with full extension soft-close.

**SOFT CLOSE FEATURE ON RAPI-MOUNT DRAWERS IS STANDARD**

# DURA-MOUNT

Ventilated Shelving System

## FOR THE BUDDING DIY-ER

*Dura-Mount is the product for you!*

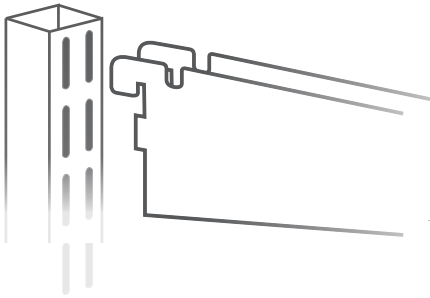

Dura-Mount is a suspended system, so nothing touches the floor. It is completely adjustable due to its clever slotted wall band supports. This allows you to change the layout of your wardrobe as your requirements change.



## ADJUSTABLE

*Dura-Mount is an adjustable shelving system that can evolve according to your changing needs over the years. Every component is attached to the wall bands via the shelf bracket and can be moved around with relative ease.*



Reach-In Dura-Mount Wardrobe

Above image features: **A** Ventilated Shelves with White Front Channel **B** Fine Mesh Basket **C** Pull-Out Shoe Rack  
**D** Long Storage Shelf **E** Hanging Rod (Long or Short Hang) **F** Pull-Out Trousers Hanger

Product description: Dura-Mount in White with White Front-Facing Channels

# WALK-IN, REACH-IN or BUILT-IN

Also suited for pantry, linen, laundry & garage storage



## FEATURES & BENEFITS

### Sturdy

The Dura-Mount system is Powder Coated Steel, which makes it incredibly strong whilst being lightweight. The channel running across the front of the shelves increases the strength further.

### Versatile

This system has adjustable components so you can alter the layout over time.

### Breathable

The shelves and drawers are wire and mesh, allowing for increased light and air-flow.

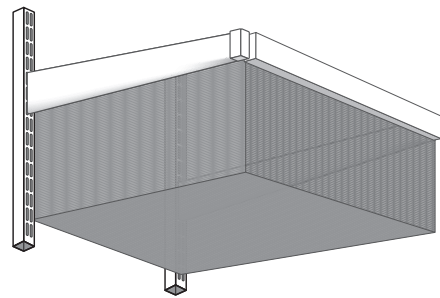

### MESH DRAWER

- Dura-Mount Shelving System Mesh allows for greater air flow
- Can be incorporated into Rapi-Mount fit-out
- Adjustable positioning



Ventilated wire shelving allows for increased light and air-flow.

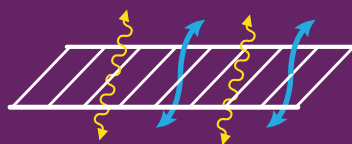

# WARDROBE DOORS

*Multi-Glide and Bi-Fold doors have a small footprint, maximising the space in your room.*

## MULTI-GLIDE DOORS

A Multi-Glide system is versatile, not only because of the endless design options, but doors can be fitted into almost any space you have. This system comes with a Soft-Close mechanism.

Our option of double & triple tracks add to the flexibility of Multi-Glide. Triple Track requires a 120mm door jamb. A double track fits to the standard 90mm door jamb.

***Soft-Close comes standard***



**ozwardrobes.com.au**

Doors come in a wide array of finishes and designs. The 'Doors' page on our website demonstrates our range, or you can visit one of our showrooms.

## BI-FOLD DOORS

Bi-Fold doors are an attractive way to conceal the contents of your wardrobe. Choose from a wide range of colours and finishes by visiting our website or showrooms.

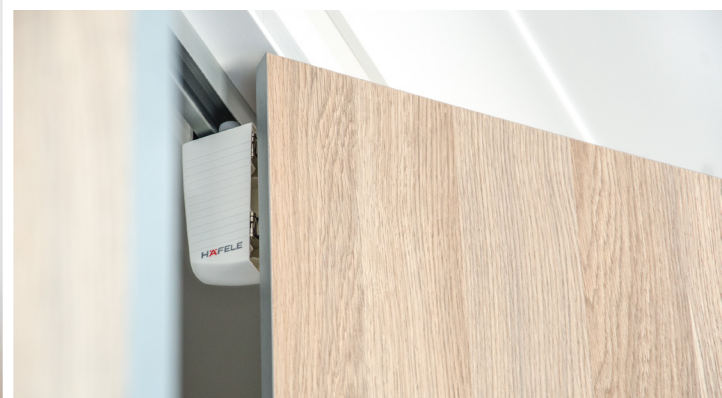



# ACCESSORIES

Accessories can personalise your space.

## PULL OUT SYSTEMS



**Pull-out Mirror**

**Pull-out Tie Hanger**

**Pull-out Trouser Rack**

Watch video clips on our website of these accessories in action!

## ACCESSORY STORAGE



**Pull-out Heel Rack**

**Fixed Shoe Rack**

**Double Jewellery Drawer**

We have a wide range of Shoe Storage options available on the Oz Wardrobes website (Products > Shoe Storage).

## OTHER USES

Talk to our team about customising Oz Wardrobes products to suit your lifestyle. From pantries, to laundries to solutions for your garage or living spaces.



**Garage Storage**

**Floating TV Cabinet**

**Laundry Storage**

The design process always begins with your vision for your space. Below are the main things to consider when dreaming up your wardrobe.

## 1 How will your wardrobe be installed into your space?

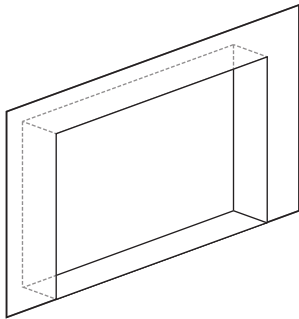

### Reach-In

You have a wardrobe system already installed and want it removed and replaced **OR** you have an empty space in your wall ready for a wardrobe.

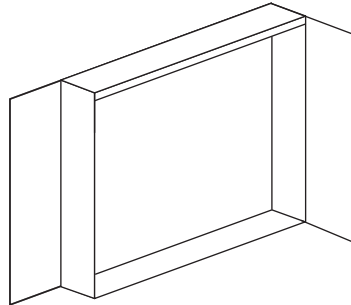

### Built-In

You do not have any wardrobe cavities in your home and will need to have a wardrobe built in front of a wall.

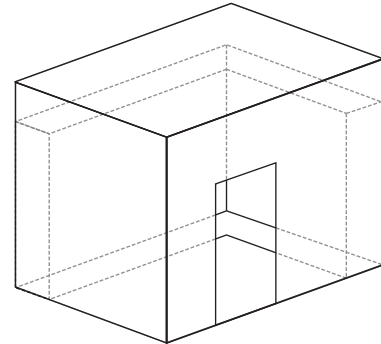

### Walk-In

You have a space big enough to accommodate this style and need an old system removed and replaced **OR** it is ready for a new wardrobe.

## 2 Which system would you like to install?

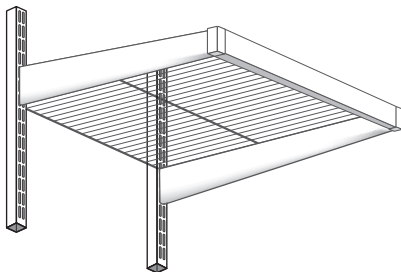

### Dura-Mount

Ventilated adjustable shelving system which adapts to your changing storage needs.

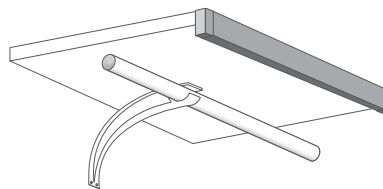

### Rapi-Mount

Solid Melamine Shelving System with a laminate finish. Huge range of colour laminate options.

## 3 What layout do you want?

There are many combinations of wardrobe layouts. We can help you with your design, and here are a few examples. Use the drawing grid on the back of this magazine to get your dream ideas down on paper.

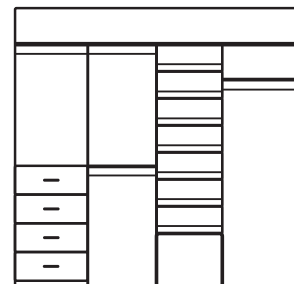
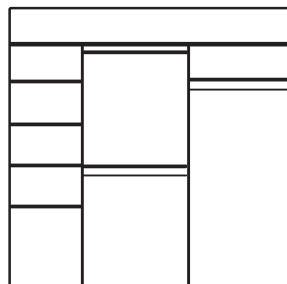
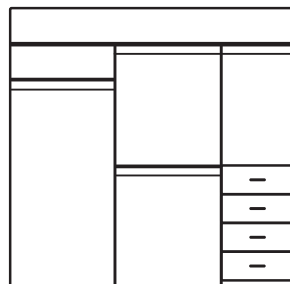
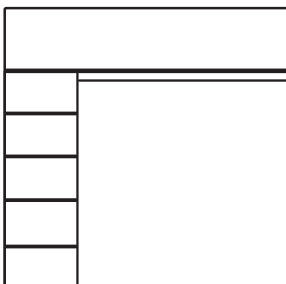

## 4 Get a free measure and quote.

Once you've decided on the foundations of your wardrobe, get in touch with us and our team will measure your space, draw up your wardrobe and get you a quote!

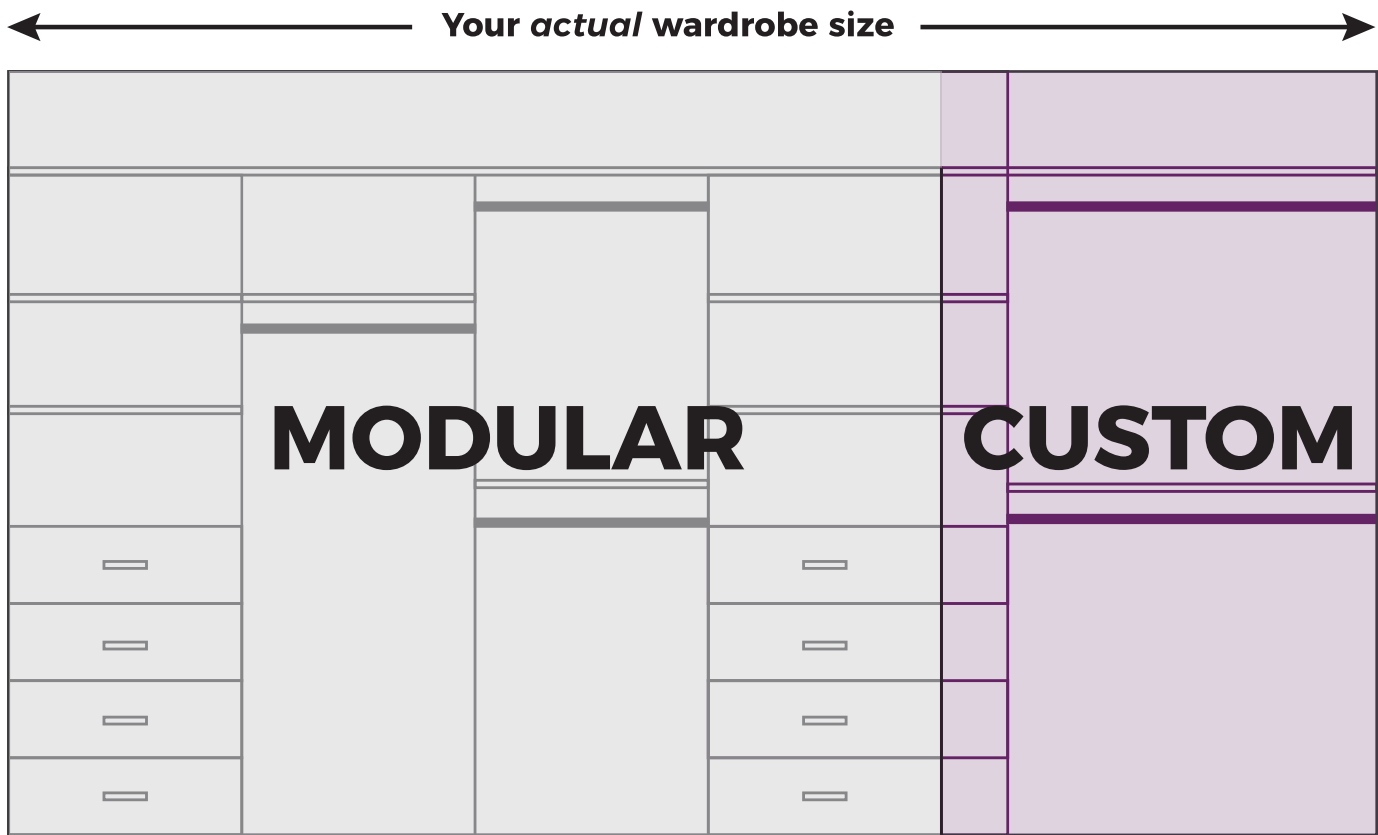

At Oz Wardrobes, we understand that wardrobes are rarely identical, so expecting a modular system to fit every situation is unrealistic. With the exception of a few components, our wardrobes are completely customisable to fit your space.

# DIY

We can install or we can supply your wardrobe as a DIY kit.\*  
We have videos online to demonstrate the installation process.

[ozwardrobes.com.au/resources/diy-instruction-videos](http://ozwardrobes.com.au/resources/diy-instruction-videos)

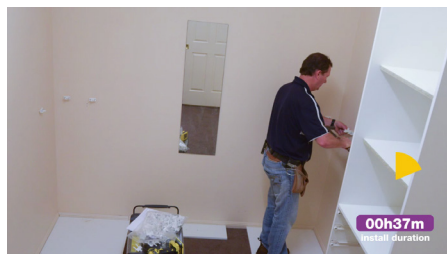

## \*Rapi-Mount, Dura-Mount and Multi-Glide Doors

We can still provide a free on-site measure and quote plus a cut-to-size service making it easier for you to install.

# MY DREAM WARDROBE



Sketch your ideas and vision on the grid below. It doesn't have to be perfect!  
Your only limit is your imagination.

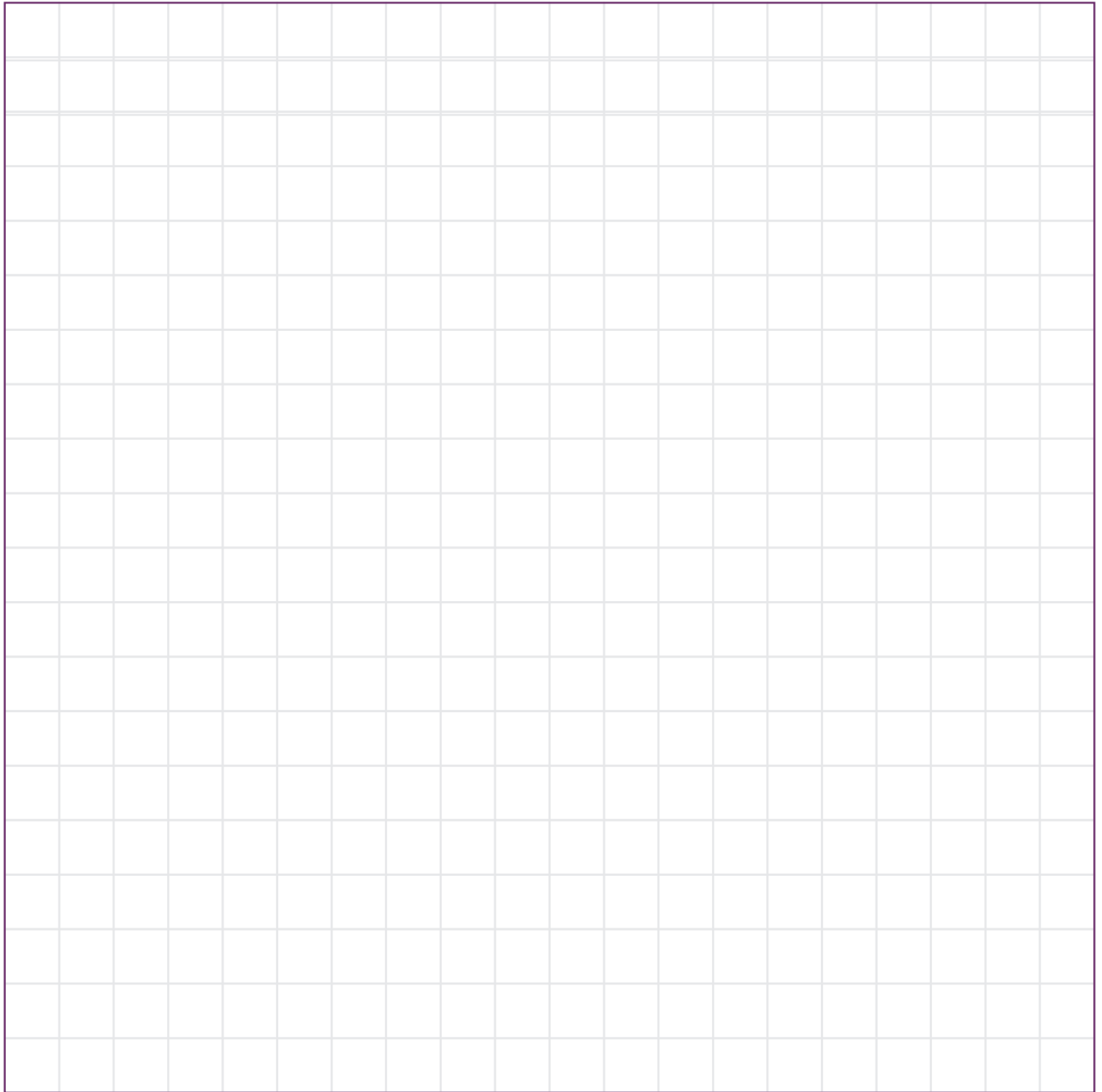

Grid: 10mm (H: 200mm x W: 200mm)

**Your local distributor:**



[ozwardrobes.com.au](http://ozwardrobes.com.au)